

MZEU

بلبرینگ قفلی

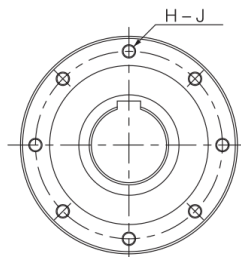

بلبرینگ علی

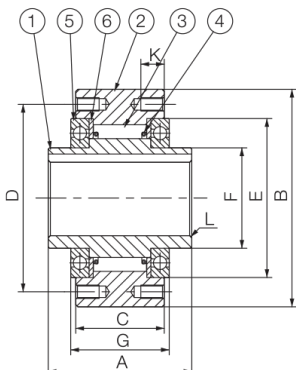

- ① Inner race
- ② Outer race
- ③ Cam
- ④ Spring
- ⑤ Bearing
- ⑥ Side plate

This drawing shows MZEU



www.1abc.ir

۰۲۱-۳۳۹۷۱۸۴۵



MZEU

بلبرینگ قفلی (یک طرف گرد ، بک استاپ)

Model	Torque Capacity (N·m)	Max. Overrunning (r/min)		Drag Torque (N·m)	Bore Size (H7)	Inner Race Keyway	A	B (h7)	C	PCD D	E	F	G	H-J	K	L	Weight (kg)
		Inner Race	Outer Race														
MZEU 12 (K)	60	2000	1000	0.20	12	4×1.8	42	62	20	51	42	20	27	3-φ5.5	—	0.8	0.5
MZEU 15 (K)	100	1800	900	0.20	15	5×2.3	52	68	28	56	47	25	32	3-M5	8	0.8	0.8
MZEU 20 (K)	245	1600	700	0.29	20	6×2.8	57	75	34	64	55	30	39	4-M5	8	0.8	1.2
MZEU 25 (K)	425	1600	600	0.33	25	8×3.3	60	90	35	78	68	40	40	4-M6	10	0.8	1.8
MZEU 30 (K)	735	1500	500	0.39	30	8×3.3	68	100	43	87	75	45	48	6-M6	10	1.0	2.6
MZEU 35 (K)	1015	1400	300	0.49	35	10×3.3	74	110	45	96	80	50	51	6-M6	12	1.0	3.2
MZEU 40 (K)	1350	1400	300	0.59	40	12×3.3	86	125	53	108	90	55	59	6-M8	14	1.3	4.8
MZEU 45 (K)	1620	1400	300	0.69	45	14×3.8	86	130	53	112	95	60	59	8-M8	14	1.3	6.2
MZEU 50 (K)	2070	1300	250	0.79	50	14×3.8	94	150	64	132	110	70	72	8-M8	14	1.3	8.2
MZEU 55 (K)	2400	1300	250	0.88	55	16×4.3	104	160	66	138	115	75	72	8-M10	16	1.5	9.5
MZEU 60 (K)	2950	1200	250	0.98	60	18×4.4	114	170	78	150	125	80	89	10-M10	16	1.5	12.3
MZEU 70 (K)	4210	1100	250	1.27	70	20×4.9	134	190	95	165	140	90	108	10-M10	16	1.8	18.1
MZEU 80 (K)	5170	800	200	1.38	80	22×5.4	144	210	100	185	160	105	108	10-M10	16	1.8	23.1
MZEU 90 (K)	12000	450	150	4.70	90	25×5.4	158	230	115	206	180	120	125	10-M12	20	2.0	28.1
MZEU100 (K)	17600	400	130	5.39	100	28×6.4	182	270	120	240	210	140	131	10-M16	24	2.0	46.3
MZEU130 (K)	24500	320	110	6.76	130	32×7.4	212	310	152	278	240	160	168	12-M16	24	2.5	70.2
MZEU150 (K)	33800	240	80	8.13	150	36×8.4	246	400	180	360	310	200	194	12-M20	32	2.5	146.3

Installation and Usage

- Model No's. MZEU12 to MZEU80 are pre-greased and require no lubrication. The operational temperature range is -40°C to +40°C.
Model No's. MZEU90 to MZEU150 require oil lubrication. (Refer to lubrication and maintenance on page 79 and 80).
- Model No's. MZEU12 to MZEU80 sprockets and other torque transmitting factors can be used with the standard flange. Refer to installation example 1.
- We recommend a Shaft tolerance of h7, and ISO R773 (DIN 6885.1) keyway is standard.
- We recommend a tolerance of E H7 for the sprocket and other parts.
- Clean the surface of both ends of the outer race and the contact surfaces of the flange, sprocket and the other parts.
- For Model No's. MZEU90 to MZEU150, apply seal adhesive to the surface of the outer race at both ends.
- Check the direction of rotation.
- When installing standard flanges, sprockets and other equipment to the clutch fit them around the bearings and screw the bolts into both ends of the outer race.
- By installing both the flange and sprocket on the opposite side, the direction of rotation can be changed.
- When mounting the clutch onto the shaft, apply pressure to inner race but never to the outer race.
- For high speed Indexing applications (More than 50 cycle/min) a strong spring type is recommended.
- Model No. MZEU

K	No Mark : No keyway on the outer race.
—	K : Keyway on the outer race.
- Please refer to page 28 for dimension of keyway on the outer race.

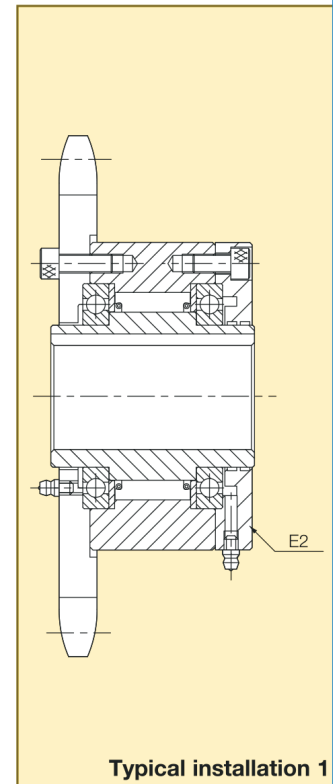

Typical installation 1