

# SERIES LMK...L

بال پوشینگ

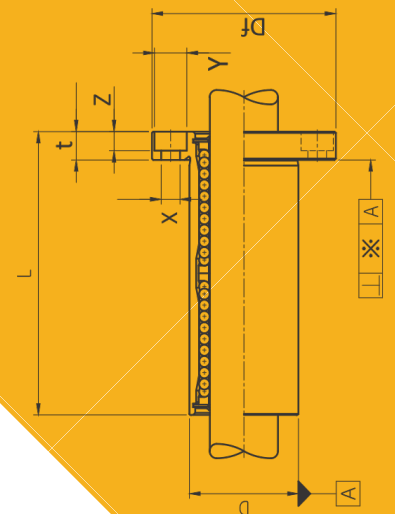

بلبرینگ عالی

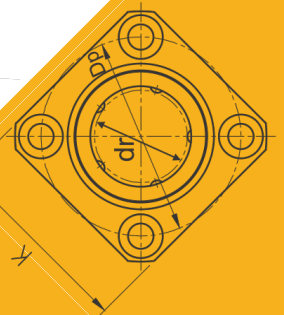

[www.1abc.ir](http://www.1abc.ir)

۰۲۱-۳۳۹۷۱۸۴۵



## SERIES LMK...L

## بال بوشینگ

Nominal shaft dia. mm	Square flange long type LMK...LUU	Weight (gf)	Eccentricity $\mu\text{m}$	Squareness $\mu\text{m}$	Basic load rating	
					Dynamic C N	Static Co N
6	LMK 6 LUU	25	15	15	323	529
8	LMK 8 LUU	43			431	784
10	LMK 10 LUU	78			588	1,100
12	LMK 12 LUU	90			813	1,570
13	LMK 13 LUU	108			813	1,570
16	LMK 16 LUU	165			1,230	2,350
20	LMK 20 LUU	225	20	20	1,400	2,740
25	LMK 25 LUU	500			1,560	3,140
30	LMK 30 LUU	590			2,490	5,490
35	LMK 35 LUU	930	25	25	2,650	6,270
40	LMK 40 LUU	1380			3,430	8,040
50	LMK 50 LUU	3400			6,080	15,900
60	LMK 60 LUU	4060			7,550	20,000

### Major dimensions and tolerance (T)

mm	dr	mm	D	mm	L	Flange							
	Tolerance $\mu\text{m}$		T $\mu\text{m}$		T $\mu\text{m}$	Df mm	K mm	t mm	Dp mm	X mm	Y mm	Z mm	
6	0-10	12	0-13	35	$\pm 300$	28	22	5	20	3.5	6	3.1	
8		15		45		32	25	5	24	3.5	6	3.1	
10		19	0-16	55		0-300	40	30	6	29	4.5	7.5	4.1
12		21		57	42		32	6	32	4.5	7.5	4.1	
13		23		61	43		34	6	33	4.5	7.5	4.1	
16		28		70	48		37	6	38	4.5	7.5	4.1	
20	0-12	32	0-19	80	0-400		54	42	8	43	5.5	9	5.1
25		40		112			62	50	8	51	5.5	9	5.1
30		45	123	74		58	10	60	6.6	11	6.1		
35	0-15	52	0-22	135		82	64	10	67	6.6	11	6.1	
40		60		151		96	75	13	78	9	14	8.1	
50		80	192	116		92	13	98	9	14	8.1		
60	0-20	90	0-25	209	134	106	18	112	11	17	11.1		